

8. Use suction cups (A) to hold the windshield over the opening, align it with the alignment marks (B) made in step 15, and set it down on the adhesive. Lightly push on the windshield until its edges are fully seated on the adhesive all the way around. Do not open or close the doors until the adhesive is dry.

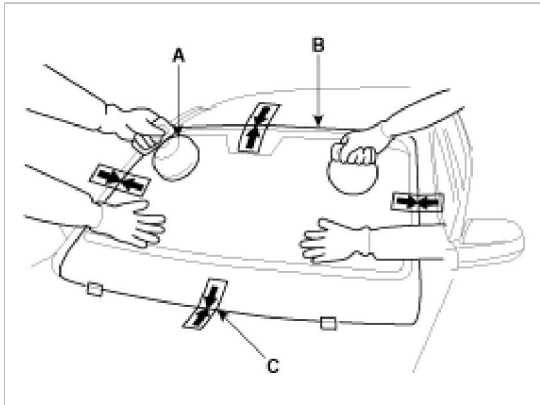

9. Scrape or wipe the excess adhesive off with a putty knife or towel. To remove adhesive from a painted surface or the windshield, wipe with a soft shop towel dampened with alcohol.
10. Let the adhesive dry for at least one hour, then spray water over the windshield and check for leaks. Make leaking areas, and let the windshield dry, then seal with sealant:
- A. Let the vehicle stand for at least four hours after windshield installation. If the vehicle has to be used within the first four, it must be driven slowly.
 - B. Keep the windshield dry for the first hour after installation.
11. Reinstall all remaining removed parts. Install the rearview mirror after the adhesive has dried thoroughly. Advise the customer not to do the following things for two the three days:
- A. Slam the door with all the windows rolled up.
 - B. Twist the body excessively (such as when going in and out of driveways at an angle or driving over rough, uneven roads)

Body (Interior and Exterior) > Bumper > Front Bumper > Components and Components Location

Components

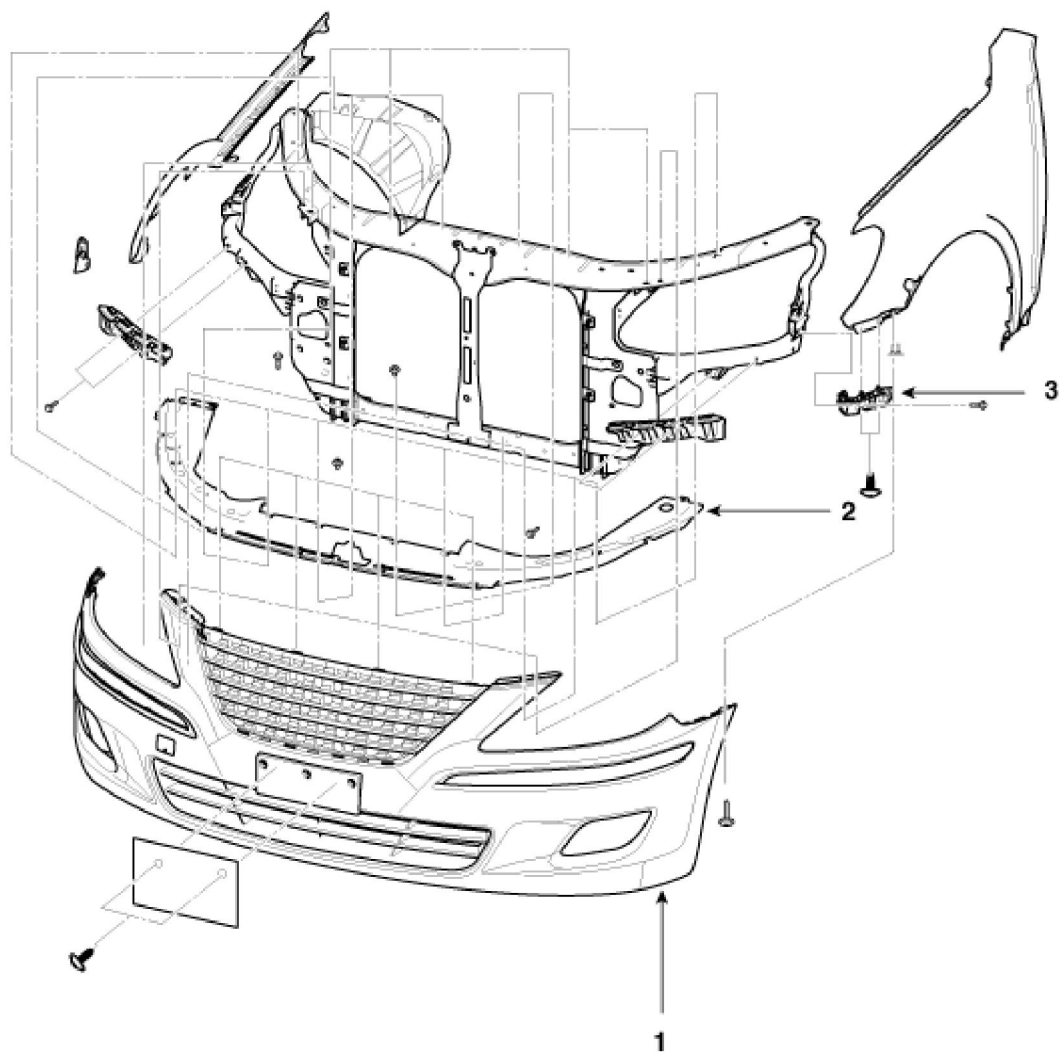

1. Front bumper cover
2. Radiator under cover

3. Front bumper side bracket

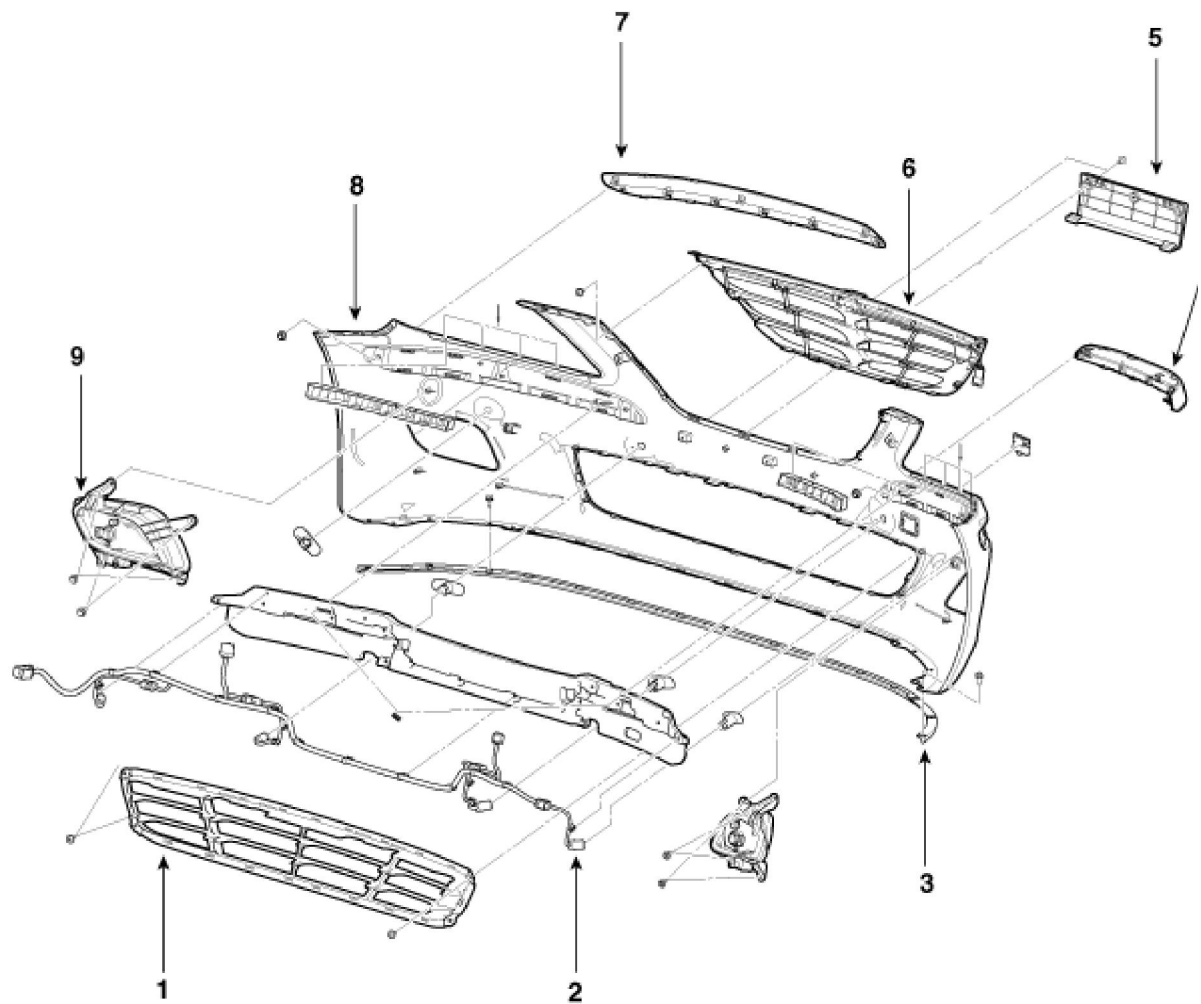

1. Front bumper air intake grill
2. Wiring
3. Front bumper lip
4. Front bumper molding

5. molding
6. Front bumper grill
7. Front bumper molding

8. Front bumper cover
9. Fog lamp

Body (Interior and Exterior) > Bumper > Front Bumper > Repair procedures

Replacement

NOTE

- Put on gloves to protect your hands.
- When prying with a flat-tip screwdriver, wrap it with protective tape to prevent damage.
- Take care not bend or scratch the cover and other parts.

1. Remove the mounting clips (A).

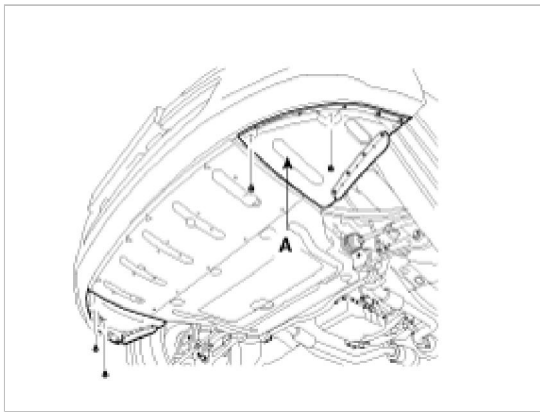

2. Remove the radiator upper cover (A).

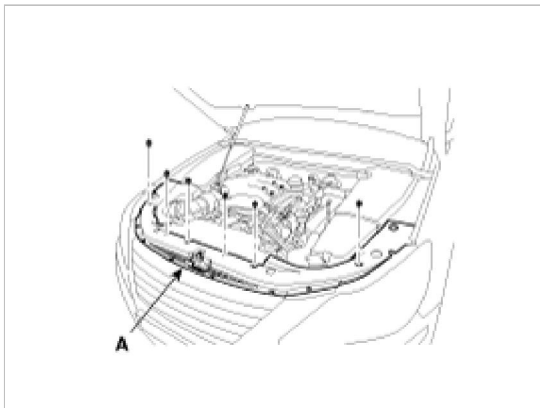

3. Remove the bumper side screw (A).

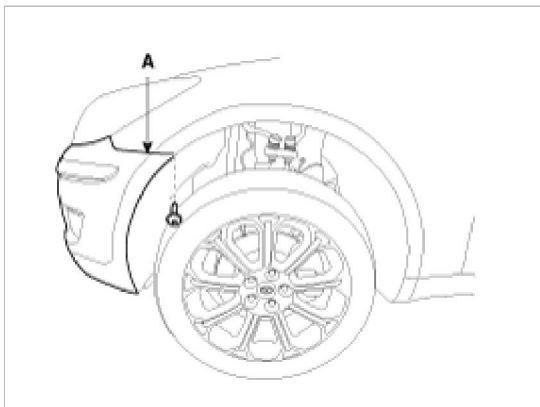

4. Disconnect the connector (A).



5. Installation is the reverse of removal.

Body (Interior and Exterior) > Bumper > Rear Bumper > Components and Components Location

Components

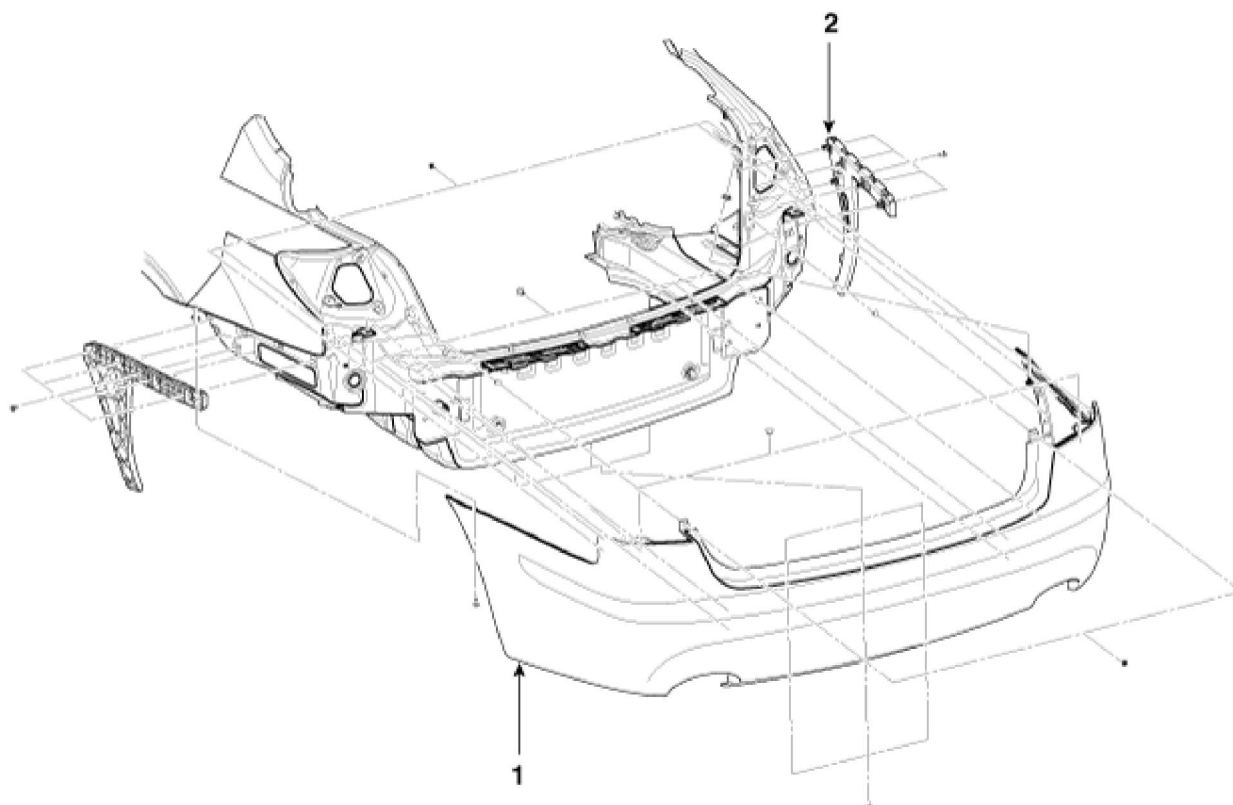

1. Rear bumper

2. Rear bumper mounting bracket

Body (Interior and Exterior) > Bumper > Rear Bumper > Repair procedures

Replacement

NOTE

- After remove the rear combination lamp.
- When prying with a flat-tip screwdriver, wrap it with protective tape, and apply protective tape around the related parts your hands.
- Put on gloves to protect your hands.
- Take care not bend or scratch the cover and other parts.

1. Remove the transverse trim.
2. Remove the luggage side trim.
3. Disconnect the connector (A).
4. Remove the rear combination lamp mounting nuts.

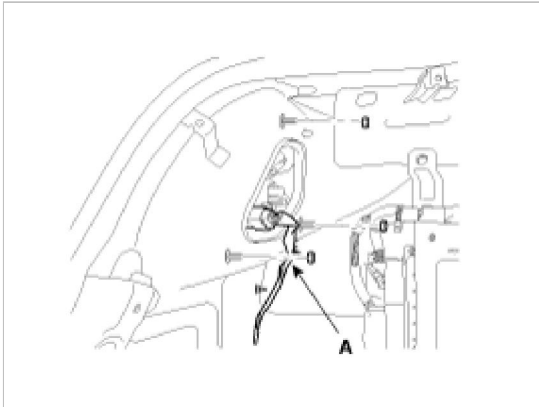

5. Remove the rear combination lamp (A).

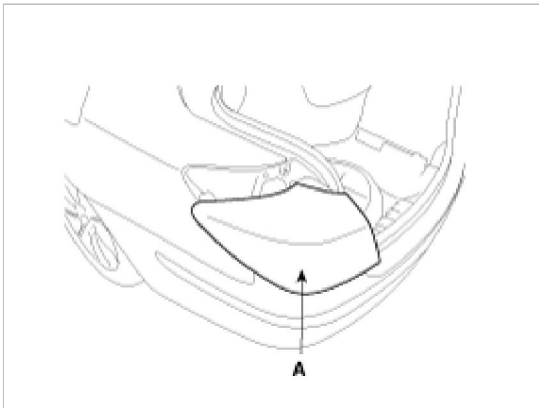

6. Remove the side bumper screws (A).

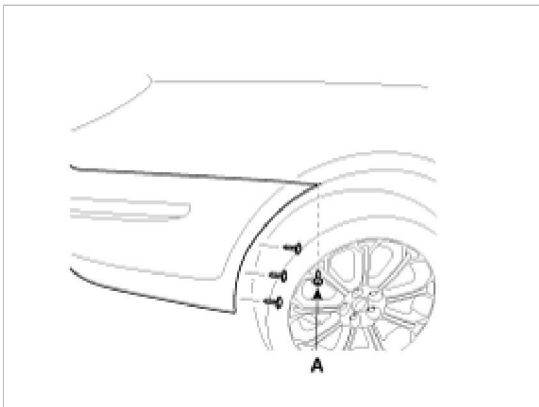

7. Remove the mounting nuts (A).

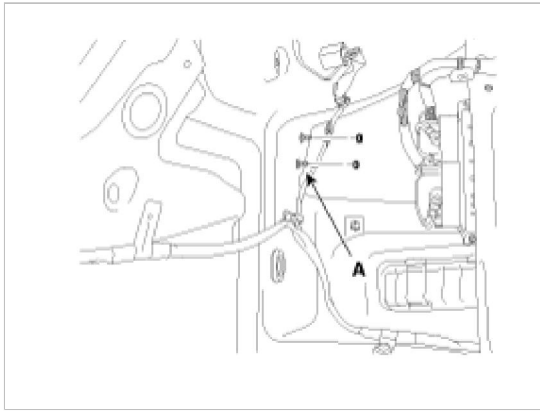

8. Disconnect the connector (A).



9. Remove the mounting bolts (A).

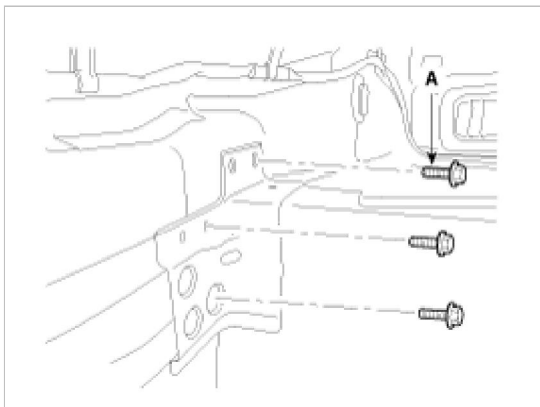

10. Loosen the rear bumper cover screws and clips.

11. Remove the rear bumper cover (A).

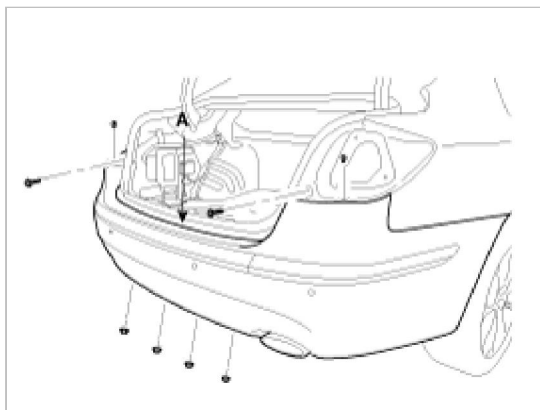

12. Installation is the reverse of removal.